

ENG. PROJECT NO. CZ:H1:2022-1

PORTION OF: T7N,R1W,S34

DRAWN BY: R. SANTIAGO

REFERENCE NUMBER: -----

PROJECT LOCATION (ADDRESS):

PROPOSED PROJECT:

APPLICANT:
WASHINGTON DEPT. of FISH & WILDLIFE
600 CAPITOL WAY N.
OLYMPIA, WA 98501-1091

FALLERT CREEK HATCHERY
1404 KALAMA RIVER RD
KALAMA, WA 98625

FALLERT CREEK HATCHERY
INTAKE DOWNSTREAM STABILIZATION

ADJACENT PROPERTY OWNER:

LAT/LONG: 46.04592' / -122.80373'

IN: FALLERT CREEK
NEAR/AT: KALAMA RIVER

1. WEYERHAEUSER TIMBER HOLDINGS INC.

DATUM: NAVD 88

COUNTY: COWLITZ

2

SHEET 1 OF 7 DATE: 05/04/2023

STATE: WA



PARCEL #:WD3401001
 OWNER: WEYERHAUSER TIMBER HOLDINGS, INC.
 ACRES: 120.00

PARCEL #:WD3409001
 OWNER: WEYERHAUSER TIMBER HOLDINGS, INC.
 ACRES: 82.57

PARCEL #:WD3409002
 OWNER: WA STATE DEPT. OF FISH & WILDLIFE
 ACRES: 0.90

PARCEL #:WD3411001
 OWNER: WA STATE DEPT. OF FISH & WILDLIFE
 ACRES: 10.63

PARCEL #:WD3403001
 OWNER: KENT WAYNE E
 ACRES: 15.07

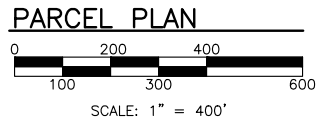
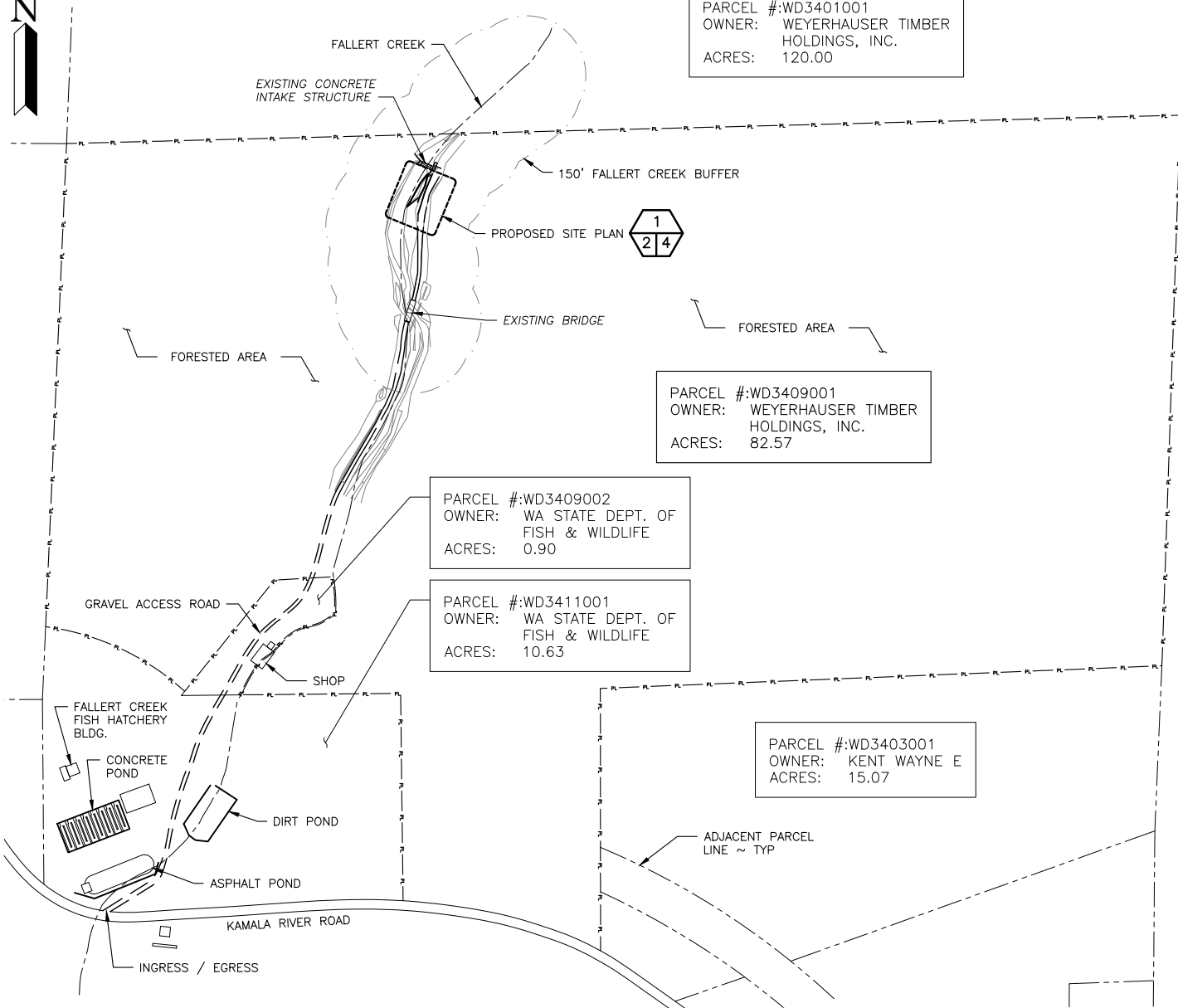

REFERENCE NUMBER: -----
 APPLICANT NAME:
 WASHINGTON DEPT. of FISH & WILDLIFE
 PROPOSED PROJECT:
 INTAKE DOWNSTREAM STABILIZATION
 LOCATION: FALLERT CREEK HATCHERY
 SHEET 2 OF 7 DATE: 05/04/2023

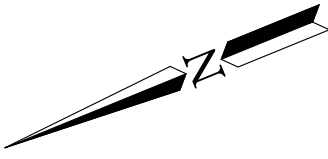

CP #1010 3/4" REBAR WITH 1 1/4"
 DIA. PINK PLASTIC WDFW CONTROL CAP.
 N: 269950.7980'
 E: 1056155.2690'
 ELEV: 87.639'
 5.5' S.E. FROM METAL SIGN POST.

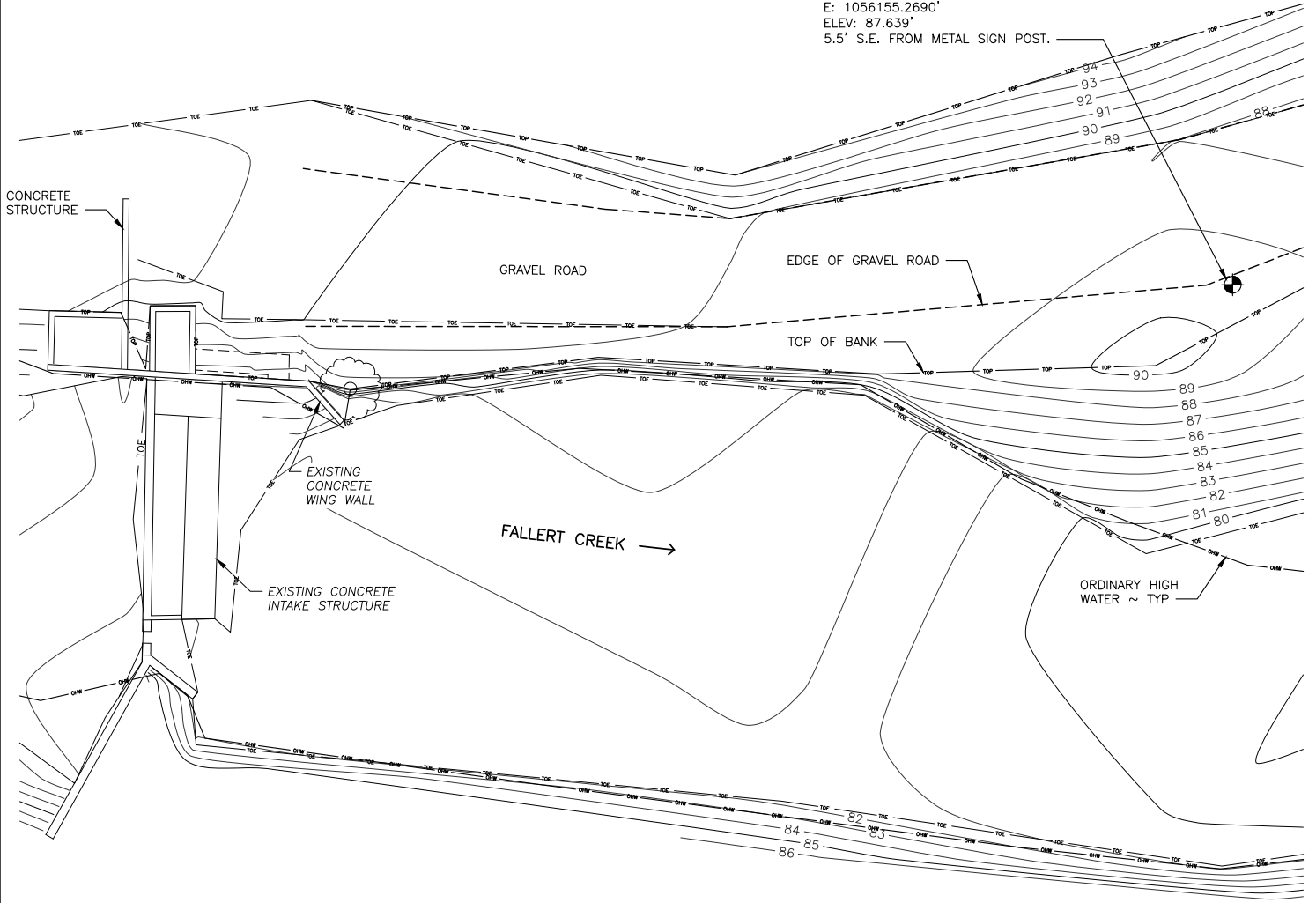

EXISTING CONDITIONS PLAN

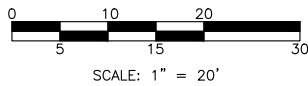

REFERENCE NUMBER: -----
 APPLICANT NAME:
 WASHINGTON DEPT. of FISH & WILDLIFE
 PROPOSED PROJECT:
 INTAKE DOWNSTREAM STABILIZATION
 LOCATION: FALLERT CREEK HATCHERY
 SHEET 3 OF 7 DATE: 05/04/2023

CUT AND FILL DATA (CUBIC YARDS)

SITE	IMPACTED AREA (SQARE FEET)	CUT ABOVE OHW	CUT BELOW OHW	FILL ABOVE OHW	FILL BELOW OHW
EARTHWORK	922.97	-	-	-	90.03

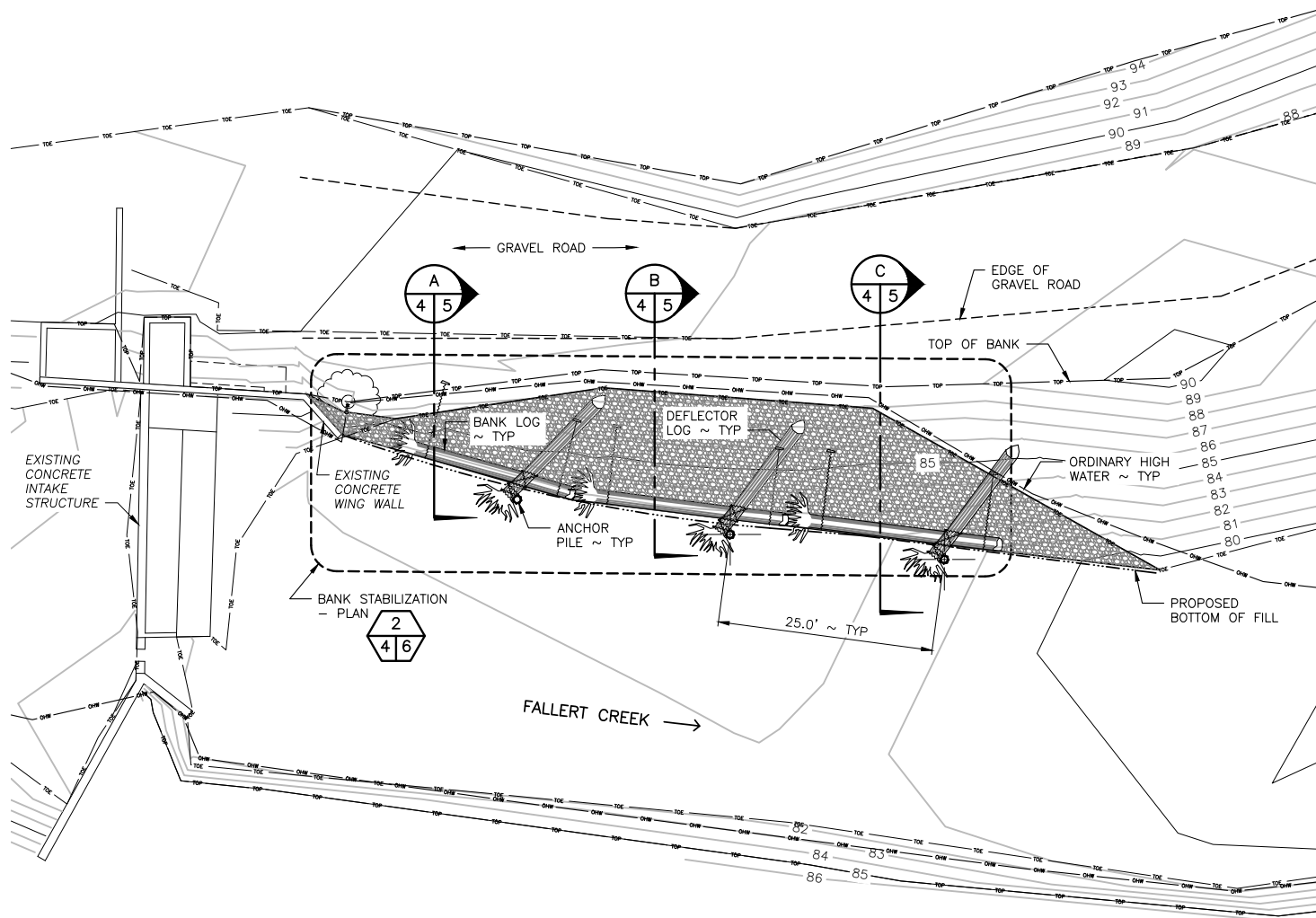
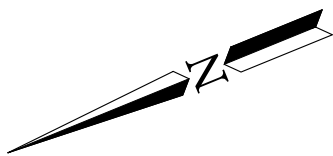

PROPOSED SITE PLAN

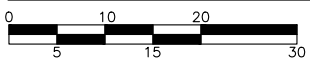

SCALE: 1" = 20'



REFERENCE NUMBER: -----
 APPLICANT NAME:
 WASHINGTON DEPT. of FISH & WILDLIFE
 PROPOSED PROJECT:
 INTAKE DOWNSTREAM STABILIZATION
 LOCATION: FALLERT CREEK HATCHERY
 SHEET 4 OF 7 DATE: 05/04/2023

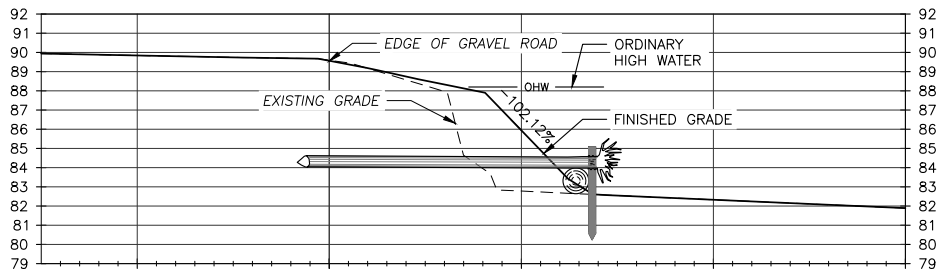

SECTION A
SCALE: 1" = 10'

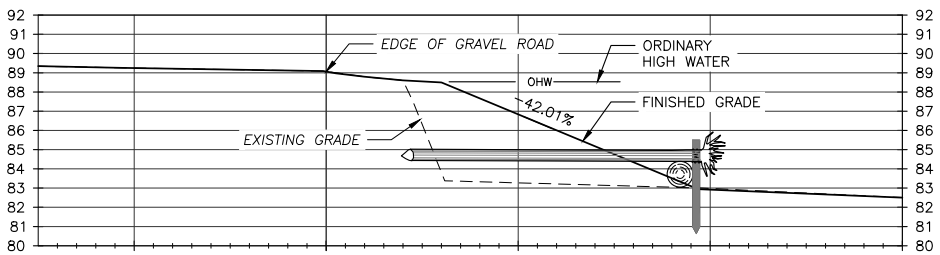

SECTION B
SCALE: 1" = 10'

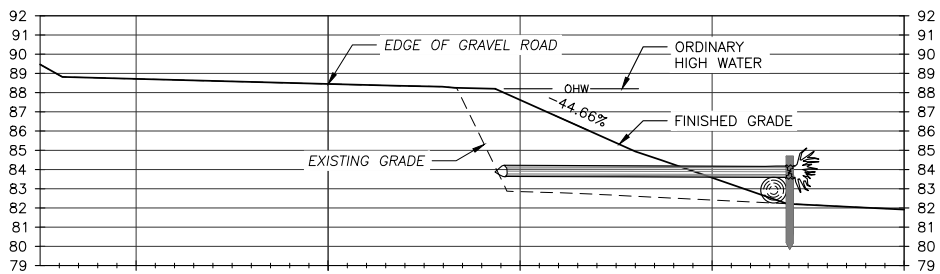

SECTION C
SCALE: 1" = 10'

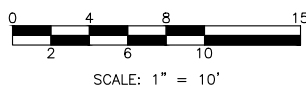

REFERENCE NUMBER: -----
 APPLICANT NAME:
 WASHINGTON DEPT. of FISH & WILDLIFE
 PROPOSED PROJECT:
 INTAKE DOWNSTREAM STABILIZATION
 LOCATION: FALLERT CREEK HATCHERY
 SHEET 5 OF 7 DATE: 05/04/2023

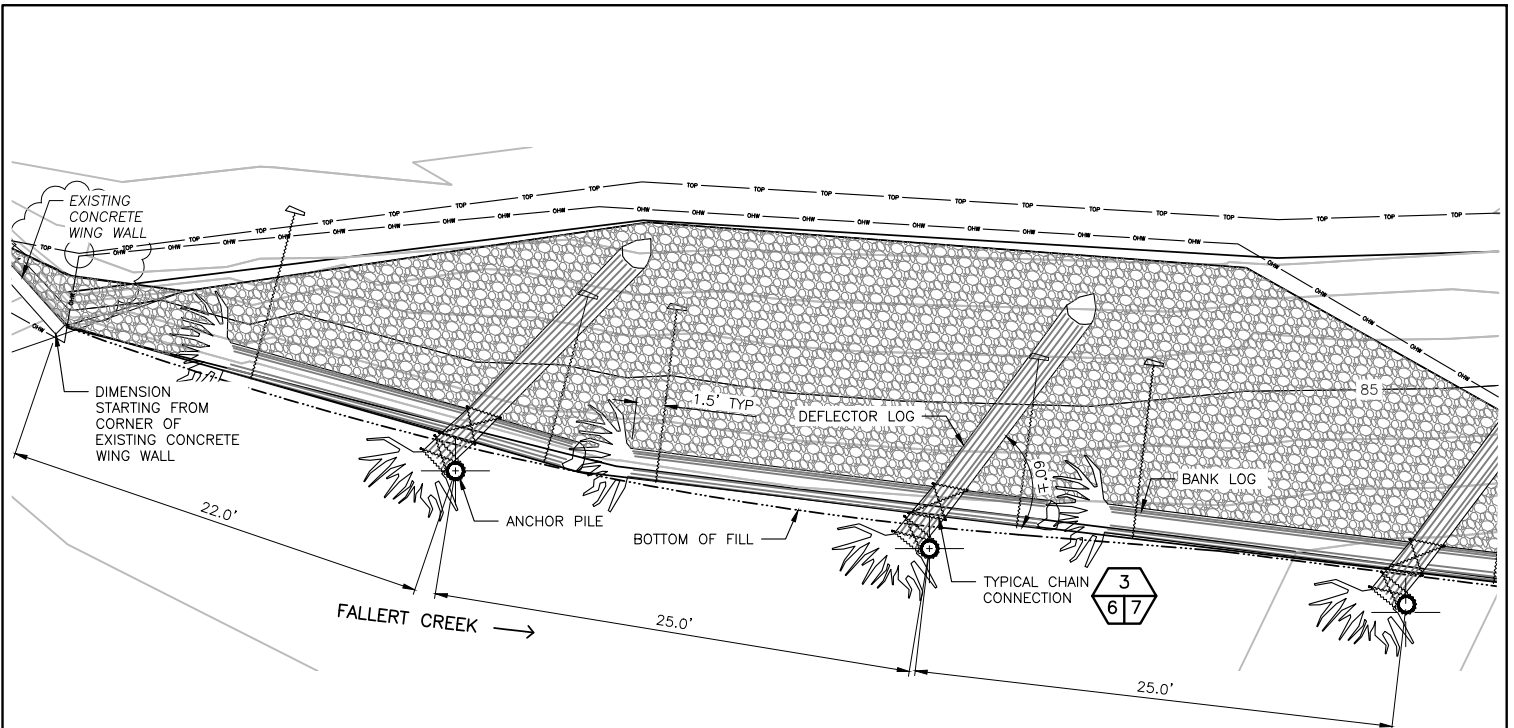

BANK STABILIZATION — PLAN 2
4 | 6

0 2 4 6 8 10 15
SCALE: 1" = 10'

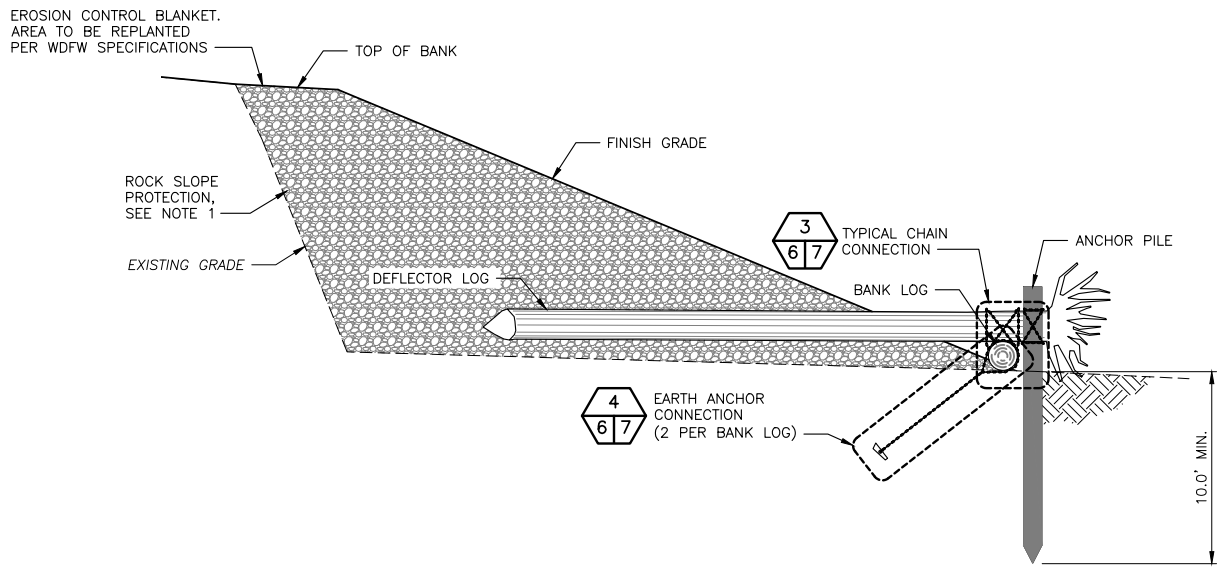

TYPICAL BANK STABILIZATION SECTION

0 2 4 6 8 10 15
SCALE: 1" = 10'

NOTE:

1. ROCK SLOPE PROTECTION PER WSDOT SPECIFICATION 9-13.4 CLASS B ROCK FOR EROSION AND SCOUR PROTECTION. MIX STREAM BED 4" COBBLES PER WSDOT SPECIFICATION 9-03.11(2) INTO NEW ROCK SLOPE PROTECTION ARMORING FILLING INTERSTITIAL VOIDS. ASSUME 10 PERCENT ROCK SLOPE PROTECTION IS 4" COBBLES.

REFERENCE NUMBER: -----
 APPLICANT NAME:
 WASHINGTON DEPT. of FISH & WILDLIFE
 PROPOSED PROJECT:
 INTAKE DOWNSTREAM STABILIZATION
 LOCATION: FALLERT CREEK HATCHERY
 SHEET 6 OF 7 DATE: 05/04/2023

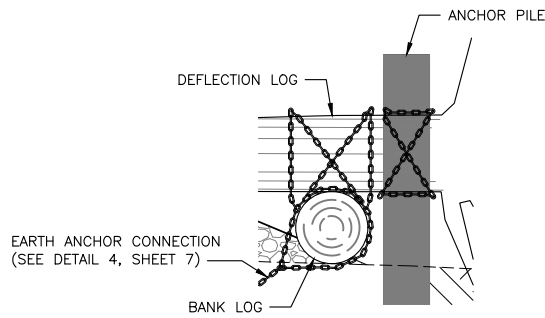

CHAIN CONNECTION DETAIL

SCALE: 1" = 4'

3
6 | 7

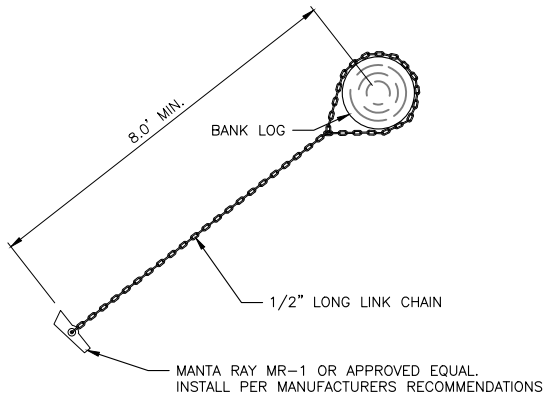

EARTH ANCHOR CONNECTION

NOT TO SCALE

4
6 | 7

NOTE:

BANK LOGS TO BE ANCHORED INTO EARTH USING 1/2" LONG LINK GALVANIZED CHAIN WRAPPED FULLY AROUND THE ENTIRE LOG CIRCUMFERENCE. A TENSIONER SHALL BE USED TO REMOVE SLACK IN THE CHAIN WHILE CONNECTING 5/8" GALVANIZED SHACKLE TO CLOSE CHAIN. 1/2"x6" (2) GALVANIZED LOG STAPLES TO BE USED AT EACH LOCATION TO SECURE CHAIN TO LOG. A TOTAL OF (2) EARTH ANCHOR CONNECTIONS TO BE INSTALLED ON EACH BANK LOG.

REFERENCE NUMBER: -----
 APPLICANT NAME:
 WASHINGTON DEPT. of FISH & WILDLIFE
 PROPOSED PROJECT:
 INTAKE DOWNSTREAM STABILIZATION
 LOCATION: FALLERT CREEK HATCHERY
 SHEET 7 OF 7 DATE: 05/04/2023