

**VICINITY MAP**  
NOT TO SCALE

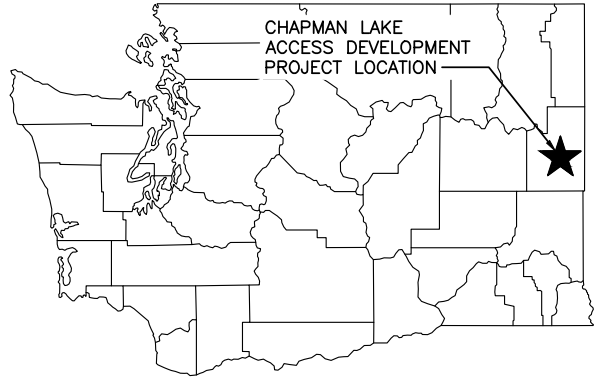

**STATE MAP**  
NOT TO SCALE

**DIRECTIONS**  
FROM CHENEY, TAKE 904 SOUTH TO S. CHENEY PLAZA ROAD. RIGHT ON CHENEY PLAZA ROAD AND TRAVEL 9.9 MILES. STAY LEFT ONTO S. CHENEY PLAZA ROAD, TRAVEL 1.4 MILES ON S. CHENEY PLAZA ROAD, ARRIVE AT START OF PROJECT ON LEFT.

ENG. PROJECT NO. SE:A801:2023-1

PORTION OF SEC 36, T.22N, R.41E

DRAWN BY: D. HENNING

REFERENCE NUMBER:

PROJECT LOCATION (ADDRESS):

PROPOSED PROJECT:

APPLICANT:  
**WASHINGTON DEPT. of FISH & WILDLIFE**  
600 CAPITOL WAY N.  
OLYMPIA, WA 98501-1091

**CHAPMAN LAKE**  
S. CHENEY PLAZA ROAD  
CHENEY, WA 99004

**CHAPMAN LAKE**  
ACCESS DEVELOPMENT

ADJACENT PROPERTY OWNER:

LAT/LONG: LAT/LONG

IN: CHAPMAN LAKE

1. JONES TRUST

DATUM: NAVD'88E

NEAR/AT: CHENEY

2

SHEET 1 OF 15 DATE: 10/02/2023

COUNTY: SPOKANE

STATE: WA

FOR WDFW  
REVIEW ONLY

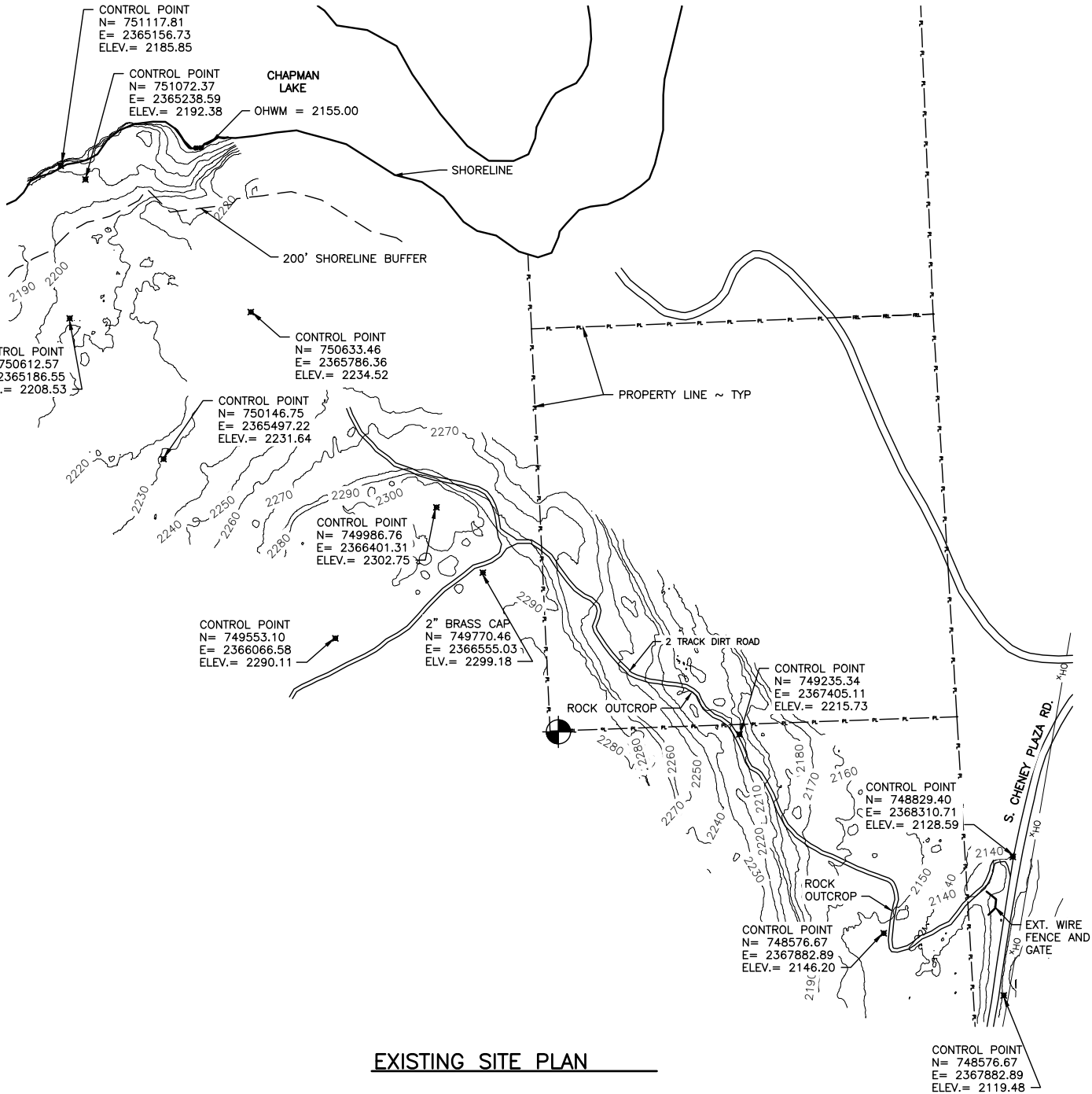

**EXISTING SITE PLAN**

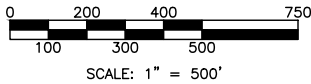

FOR WDFW  
REVIEW ONLY

REFERENCE NUMBER:  
 APPLICANT NAME:  
 WASHINGTON DEPT. of FISH & WILDLIFE  
 PROPOSED PROJECT:  
 ACCESS DEVELOPMENT  
 LOCATION: CHAPMAN LAKE  
 SHEET 2 OF 15 DATE: 10/02/2023

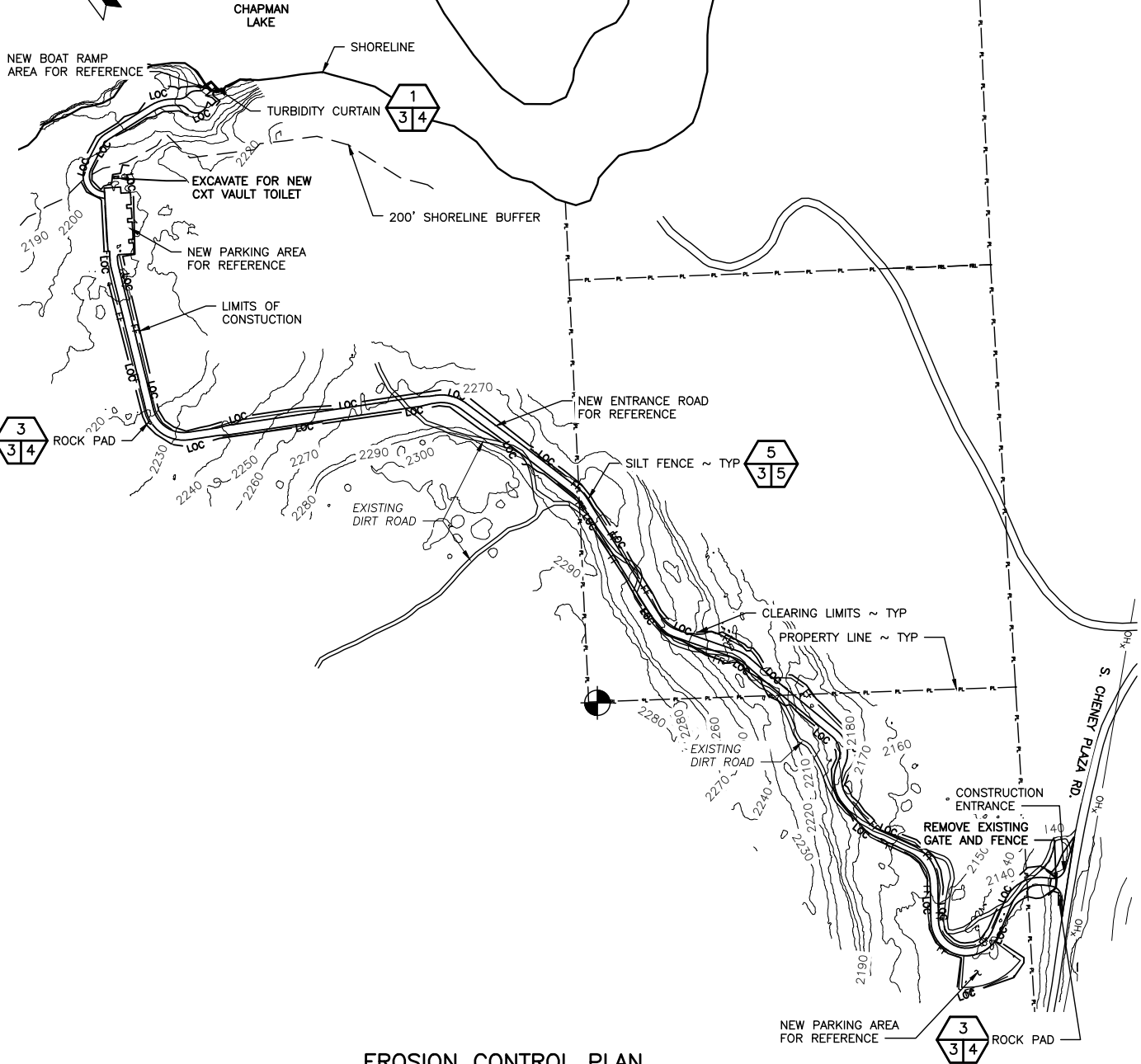
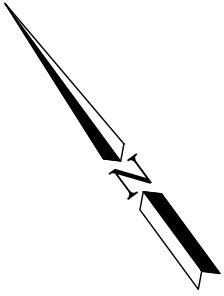

**EROSION CONTROL PLAN**

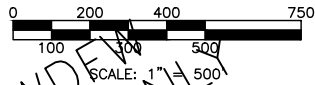

FOR WDEW  
REVIEW ONLY

REFERENCE NUMBER:  
 APPLICANT NAME:  
 WASHINGTON DEPT. of FISH & WILDLIFE  
 PROPOSED PROJECT:  
 ACCESS DEVELOPMENT  
 LOCATION: CHAPMAN LAKE  
 SHEET 3 OF 15 DATE: 10/02/2023

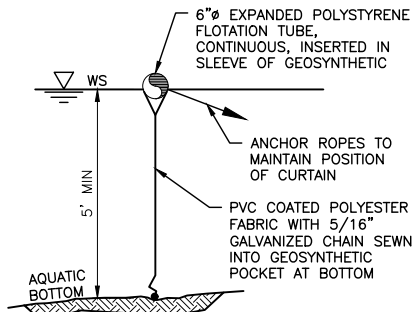

**TURBIDITY CURTAIN**

NOT TO SCALE



**NOTES:**

- 1. FABRIC IS 22 OUNCES PER SQUARE YARD

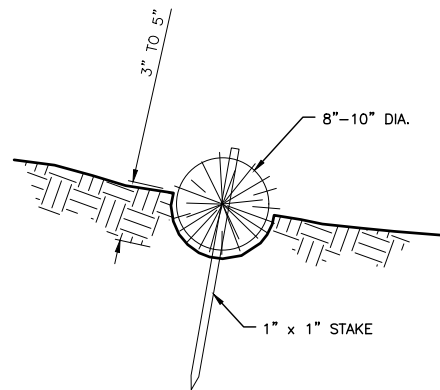

**STRAW WATTLE DETAIL**

NOT TO SCALE



**CONSTRUCTION NOTES:**

1. PREPARE THE SLOPE BEFORE THE WATTLING PROCEDURE IS STARTED.
2. SMOOTH SHALLOW GULLIES AS WORK PROGRESSES.
3. DIG SMALL TRENCHES ACROSS THE SLOPE ON CONTOUR, TO PLACE ROLLS IN. THE TRENCH SHOULD BE DEEP ENOUGH TO ACCOMMODATE HALF THE THICKNESS OF THE ROLL. WHEN THE SOIL IS LOOSE AND UNCOMPACTED, THE TRENCH SHOULD BE DEEP ENOUGH TO BURY THE ROLL 2/3 OF ITS THICKNESS BECAUSE THE GROUND WILL SETTLE.
4. ROLLS SHALL BE INSTALLED PERPENDICULAR TO WATER MOVEMENT, PARALLEL TO THE SLOPE CONTOUR.
5. BUILD TRENCHES AND INSTALL ROLLS FROM THE BOTTOM OF THE SLOPE AND WORK UP.
6. CONSTRUCT TRENCHES AT CONTOUR INTERVALS 3-12 FEET APART DEPENDING ON STEEPNESS OF SLOPE. THE STEEPER THE SLOPE, THE CLOSER TOGETHER THE TRENCHES. 1:1=10' 2:1=20' 3:1=30' 4:1=40'
7. LAY THE ROLL ALONG THE TRENCHES FITTING IT SNUGLY AGAINST THE SOIL. MAKE SURE NO GAPS EXIST BETWEEN THE SOIL AND THE STRAW WATTLE.
8. USE A STRAIGHT BAR TO DRIVE HOLES THROUGH THE WATTLE AND INTO THE SOIL FOR THE WILLOW OR WOODEN STAKES.
9. DRIVE THE STAKE THROUGH PREPARED HOLE INTO SOIL. LEAVE ONLY 1 OR 2 INCHES OF STAKE EXPOSED ABOVE ROLL.
10. IF USING WILLOW STAKES REFER TO LIVE STAKING BEST MANAGEMENT PRACTICES.
11. INSTALL STAKES AT LEAST EVERY 4 FEET APART THROUGH THE WATTLE. ADDITIONAL STAKES MAY BE DRIVEN ON THE DOWNSLOPE SIDE OF THE TRENCHES ON HIGHLY EROSION OR VERY STEEP SLOPES.
12. INSPECT THE STRAW ROLLS AND THE SLOPES AFTER SIGNIFICANT STORMS. MAKE SURE THE ROLLS ARE IN CONTACT WITH THE SOIL.
13. REPAIR ANY RILLS OR GULLIES PROMPTLY.
14. RESEED OR REPLANT VEGETATION IF NECESSARY UNTIL SLOPES ARE STABILIZED.

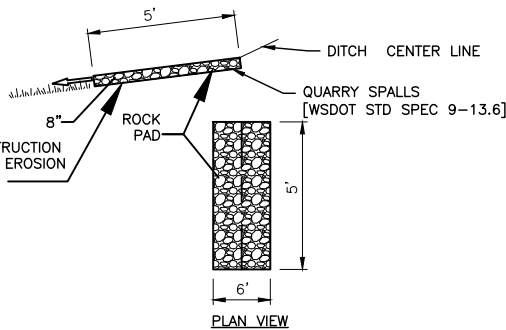

CLASS A NON-WOVEN CONSTRUCTION GEOTEXTILE FOR PERMANENT EROSION CONTROL HIGH SURVIVABILITY

**ROCK PAD DETAIL**

(NOT TO SCALE)

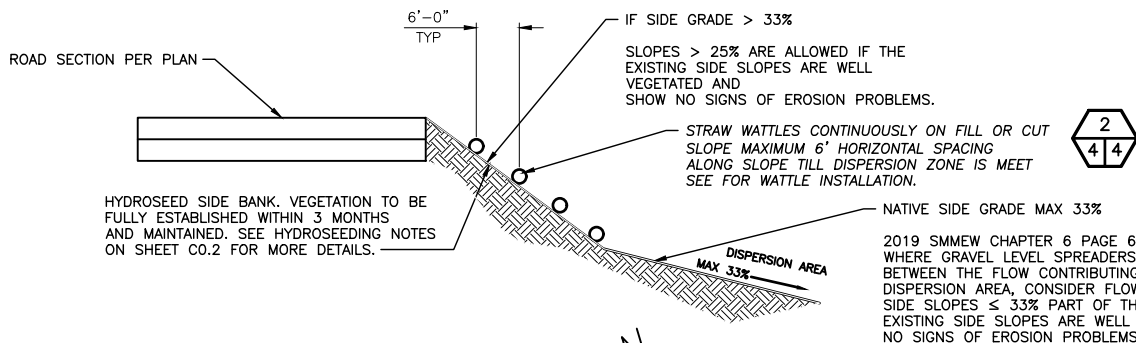

**SLOPE TREATMENT DETAIL**

(NOT TO SCALE)



FOR REVIEW ONLY

REFERENCE NUMBER:

APPLICANT NAME:

WASHINGTON DEPT. of FISH & WILDLIFE

PROPOSED PROJECT:

ACCESS DEVELOPMENT

LOCATION: CHAPMAN LAKE

SHEET 4 OF 15 DATE: 10/02/2023

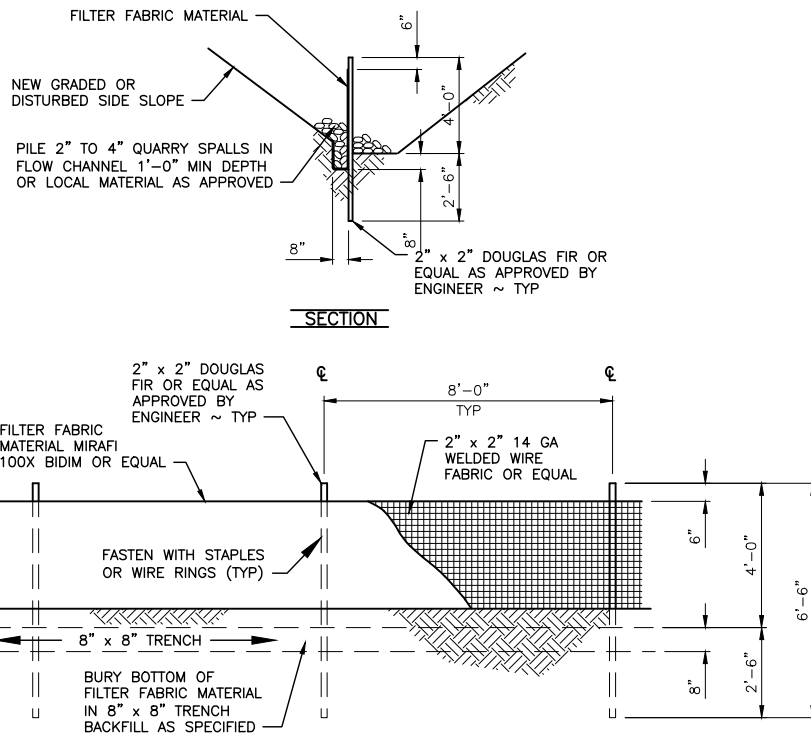

**FILTER FABRIC FENCE** 5  
 NOT TO SCALE 3 | 5

**NOTES:**

1. FILTER FABRIC SHALL BE PURCHASED CONTINUOUS ROLL CUT TO LENGTH OF BARRIER AS NEEDED. IF JOINTS ARE NECESSARY FABRIC SHALL BE SPLICED TOGETHER ONLY AT SUPPORT POSTS WITH A MINIMUM OF (6) INCH OVERLAP. BOTH ENDS SHALL BE SECURED AS REQUIRED.
2. FILTER FABRIC SHALL BE INSTALLED TO FOLLOW CONTOURS. FENCE POSTS SHALL BE SPACED A MAXIMUM OF EIGHT (8) FEET APART UNLESS OTHERWISE SHOWN HEREIN. ALL POSTS SHALL BE DRIVEN INTO THE GROUND A MINIMUM OF 30 INCHES.
3. A TRENCH SHALL BE EXCAVATED, ROUGHLY EIGHT (8) INCHES WIDE BY EIGHT (8) INCHES DEEP UP SLOPE AND ADJACENT TO THE POST TO ALLOW THE FILTER FABRIC TO BE BURIED.
4. WHEN STANDARD STRENGTH FILTER FABRIC IS UTILIZED, A WIRE SINGLE SPACE MESH SUPPORT FENCE SHALL BE FASTENED TO THE UPSLOPE (OR UPSTREAM) SIDE OF THE POSTS USING ONE (1) INCH MINIMUM LENGTH WIRE STAPLES, TIE WIRE OR APPROVED HOG RINGS. ALL WIRE SUPPORT SHALL EXTEND INTO THE TRENCH A MINIMUM OF FOUR (4) INCHES AND SHALL NOT EXTEND MORE THAN 36 INCHES ABOVE ORIGINAL GRADE.
5. ALL FILTER FABRIC SHALL BE STAPLED OR WIRED TO SUPPORT FENCING AND A MINIMUM OF 20 INCHES OF FABRIC SHALL BE EXTENDED INTO THE TRENCH. FILTER FABRIC SHALL NOT BE STAPLED OR FASTENED TO EXISTING TREES OR STRUCTURES UNLESS OTHERWISE APPROVED BY THE ENGINEER.
6. IF HIGH STRENGTH FILTER FABRIC AND CLOSER SPACING ARE USED, THE WIRE SUPPORT FENCING MAY BE ELIMINATED. HIGH STRENGTH FABRIC SHALL BE STAPLED OR WIRED DIRECTLY TO POSTS AS REQUIRED BY THE ENGINEER.
7. CUTOFF TRENCH SHALL BE BACKFILLED WITH 3/4 INCH MINIMUM DIAMETER WASHED GRAVEL OR OTHER SIMILAR SOURCE AS APPROVED BY THE ENGINEER.
8. FILTER FENCING SHALL BE INSTALLED WHERE SHOWN ON THE PLAN, OR AS MARKED IN THE FIELD BY THE ENGINEER, PRIOR TO COMMENCEMENT OF WORK. ALL FENCING SHALL BE INSPECTED DAILY DURING CONSTRUCTION AND AFTER EACH SIGNIFICANT RAINFALL EVENT UNTIL SITE HAS BEEN PERMANENTLY STABILIZED. ANY REQUIRED REPAIRS SHALL BE MADE IMMEDIATELY.
9. REMOVAL OF TRAPPED SEDIMENT SHALL BE PERFORMED WHEN AMOUNTS REACH APPROXIMATELY 1/3 HEIGHT OF THE FENCE. MATERIAL REMOVED FROM FENCE SHALL BE DISPOSED OF AT AN APPROVED OFFSITE LOCATION UNLESS OTHERWISE DIRECTED BY THE ENGINEER.
10. FILTER FENCING SHALL REMAIN IN-PLACE UNTIL SITE HAS BEEN REVEGETATED TO ORIGINAL CONDITION OR DIRECTED BY THE ENGINEER.

FOR WDFW  
REVIEW ONLY

REFERENCE NUMBER:  
 APPLICANT NAME:  
 WASHINGTON DEPT. of FISH & WILDLIFE  
 PROPOSED PROJECT:  
 ACCESS DEVELOPMENT  
 LOCATION: CHAPMAN LAKE  
 SHEET 5 OF 15 DATE: 10/02/2023

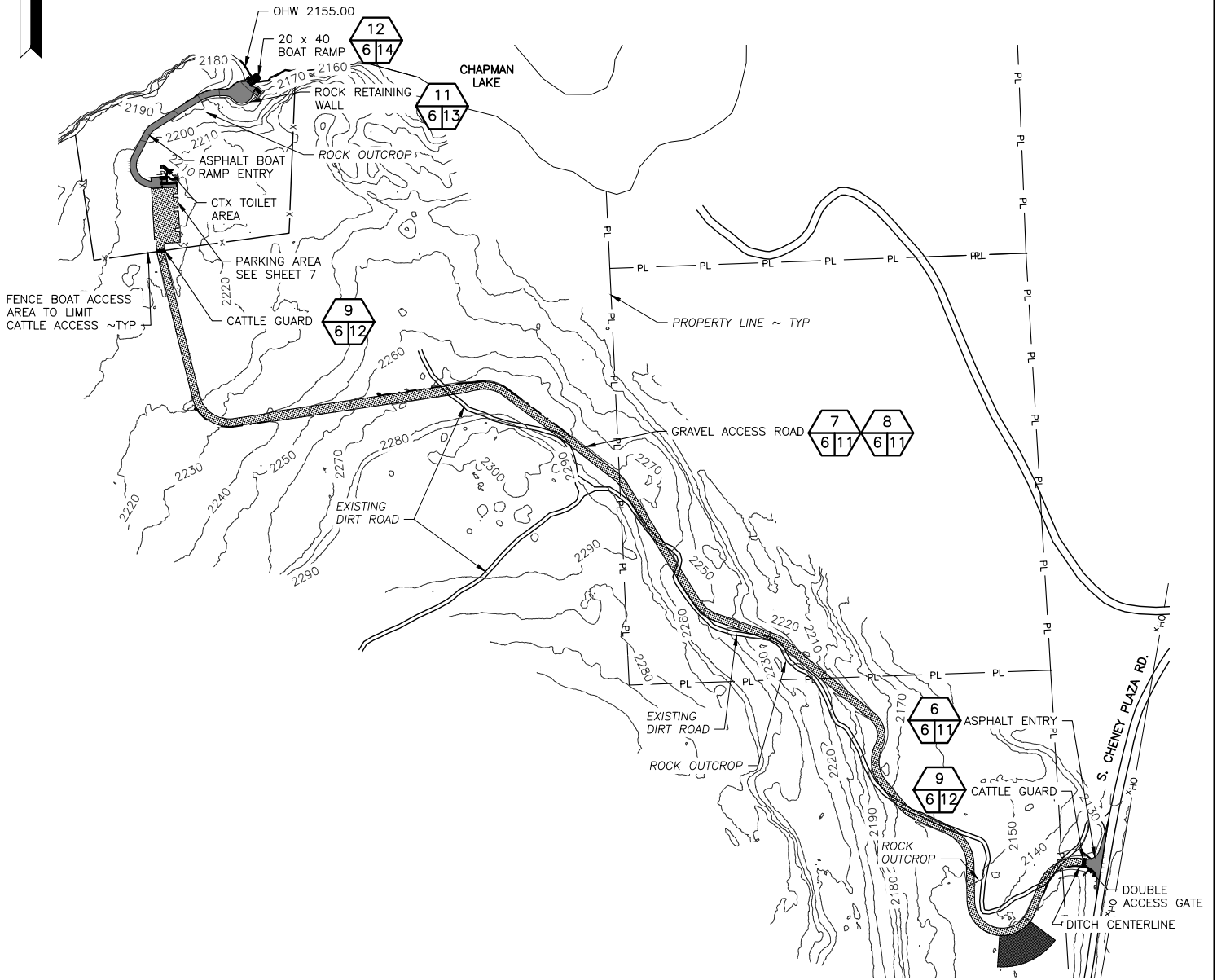

**SITE PLAN**



SCALE: 1" = 500'

FOR WDFW  
REVIEW ONLY

REFERENCE NUMBER:  
 APPLICANT NAME:  
 WASHINGTON DEPT. of FISH & WILDLIFE  
 PROPOSED PROJECT:  
 ACCESS DEVELOPMENT  
 LOCATION: CHAPMAN LAKE  
 SHEET 6 OF 15 DATE: 10/02/2023

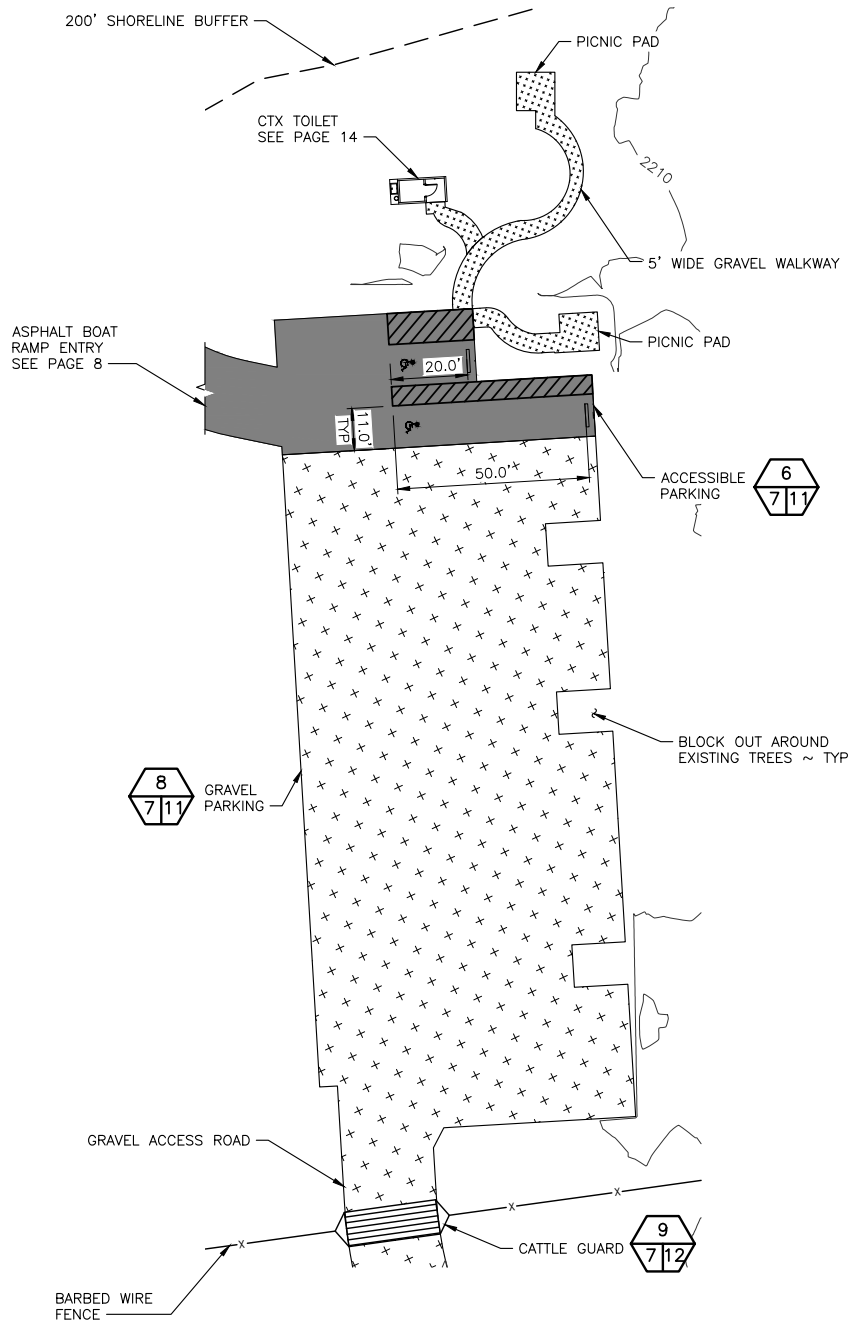

**PARKING AREA PLAN**

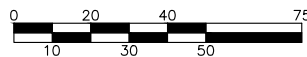

SCALE: 1" = 50'

FOR WDFW  
REVIEW ONLY

REFERENCE NUMBER:  
APPLICANT NAME:  
WASHINGTON DEPT. of FISH & WILDLIFE  
PROPOSED PROJECT:  
ACCESS DEVELOPMENT  
LOCATION: CHAPMAN LAKE  
SHEET 7 OF 15 DATE: 10/02/2023

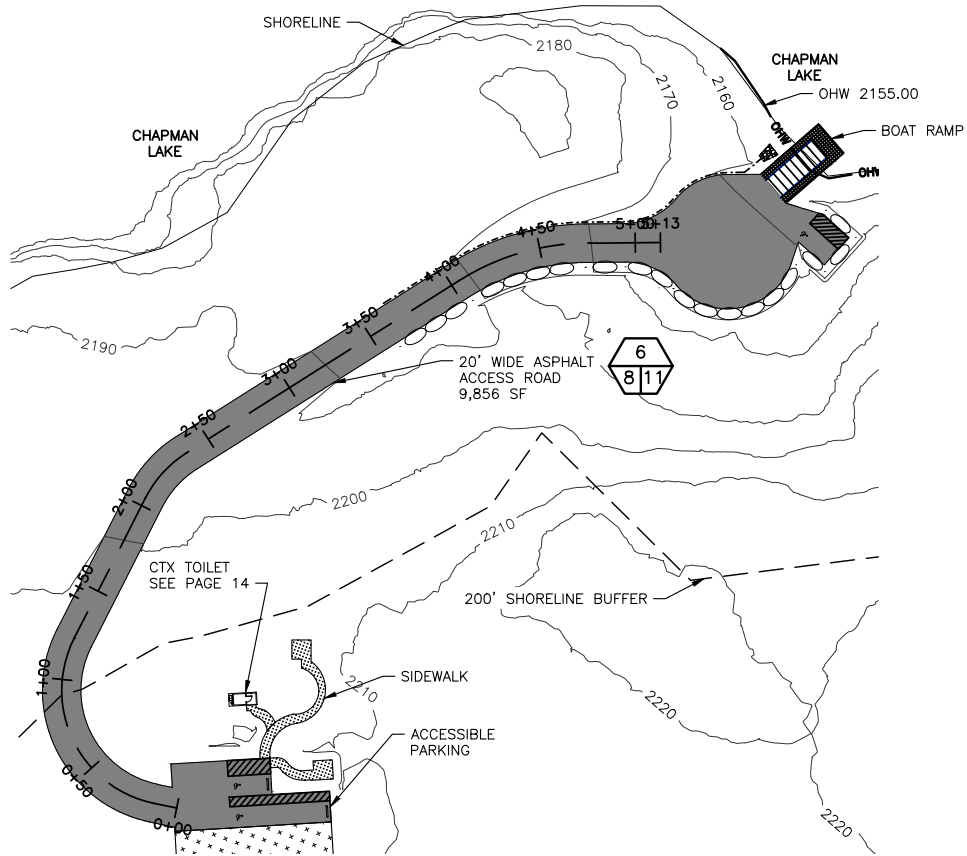

**BOAT RAMP ACCESS PLAN**

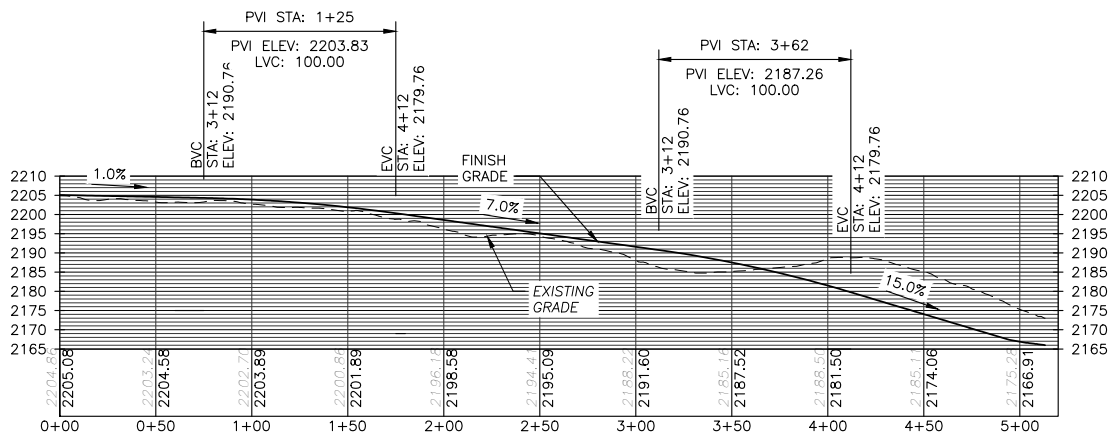
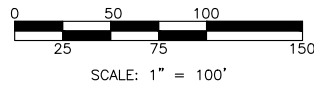

**BOAT RAMP ACCESS PROFILE**

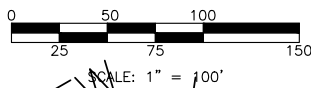

FOR WDFW  
REVIEW ONLY

REFERENCE NUMBER:  
 APPLICANT NAME:  
 WASHINGTON DEPT. of FISH & WILDLIFE  
 PROPOSED PROJECT:  
 ACCESS DEVELOPMENT  
 LOCATION: CHAPMAN LAKE  
 SHEET 8 OF 15 DATE: 10/02/2023



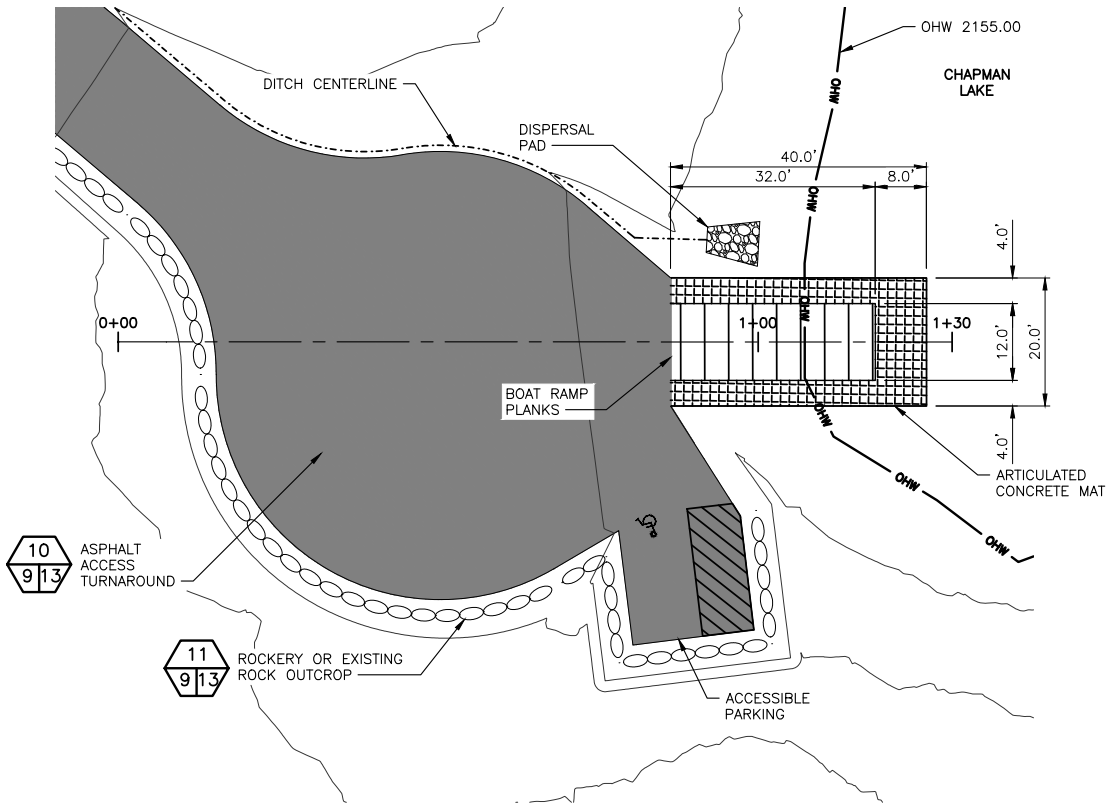
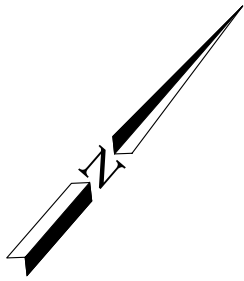

**BOAT RAMP PLAN**

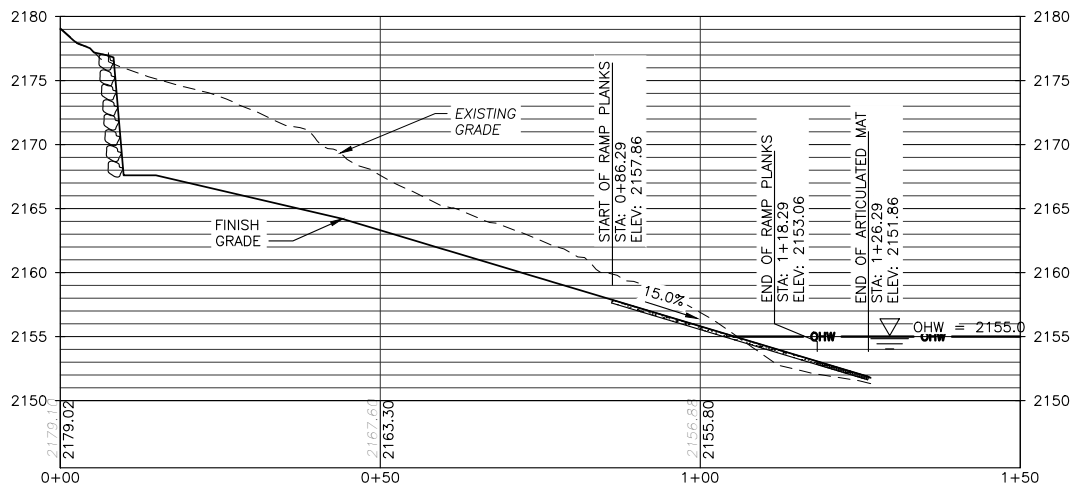
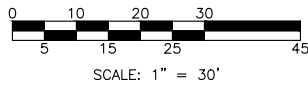

**BOAT RAMP PROFILE**

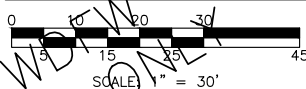

FOR WDFW  
REVIEW ONLY

REFERENCE NUMBER:  
 APPLICANT NAME:  
 WASHINGTON DEPT. of FISH & WILDLIFE  
 PROPOSED PROJECT:  
 ACCESS DEVELOPMENT  
 LOCATION: CHAPMAN LAKE  
 SHEET 9 OF 15 DATE: 10/02/2023

BOAT RAMP CUT AND FILL (CY)					
MATERIAL	CUT ABOVE OHW	CUT BELOW OHW	FILL ABOVE OHW	FILL BELOW OHW	TOTAL
EXISTING NATIVE MATERIAL	13.08	11.61	--	--	24.69
CONCRETE PLANKS	--	--	4.66	2.46	7.12
ARTICULATED CONCRETE MAT	--	--	3.19	4.52	7.71
1-1/4" CRUSHED ROCK	--	--	5.23	4.63	9.87
TOTAL	13.08	11.61	13.08	11.61	

BOAT RAMP IMPERVIOUS SURFACE (SF)			
AREA	ABOVE OHW	BELOW OHW	TOTAL
CONCRETE PLANKS	251.59	132.41	384.00
CONCRETE ARTICULATED MAT	172.31	243.31	415.62

GRAVEL ACCESS ROAD AND PARKING CUT AND FILL (CY)			
MATERIALS	CUT ABOVE OHW	FILL ABOVE OHW	TOTAL
ASPHALT (HMA)	--	36.92	36.92
NATIVE MATERIAL	3113.63	--	-3113.63
CSTC	--	889.61	889.61
CSBC	--	1334.41	1334.41

GRAVEL ACCESS ROAD IMPERVIOUS SURFACE	
AREA	TOTAL
EXISTING IMPERVIOUS SURFACE:	52,817.40 SF
PROPOSED IMPERVIOUS SURFACE	144,116.35 SF

FOR WDFW  
REVIEW ONLY

REFERENCE NUMBER:  
 APPLICANT NAME:  
 WASHINGTON DEPT. of FISH & WILDLIFE  
 PROPOSED PROJECT:  
 ACCESS DEVELOPMENT  
 LOCATION: CAPMAN LAKE  
 SHEET 10 OF 15 DATE: 10/02/2023

SHOULD COMPETENT ROCK BE ENCOUNTERED AS DETERMINED BY OWNER/INSPECTOR A STEEPER CATCH SLOPE MAYBE USED.

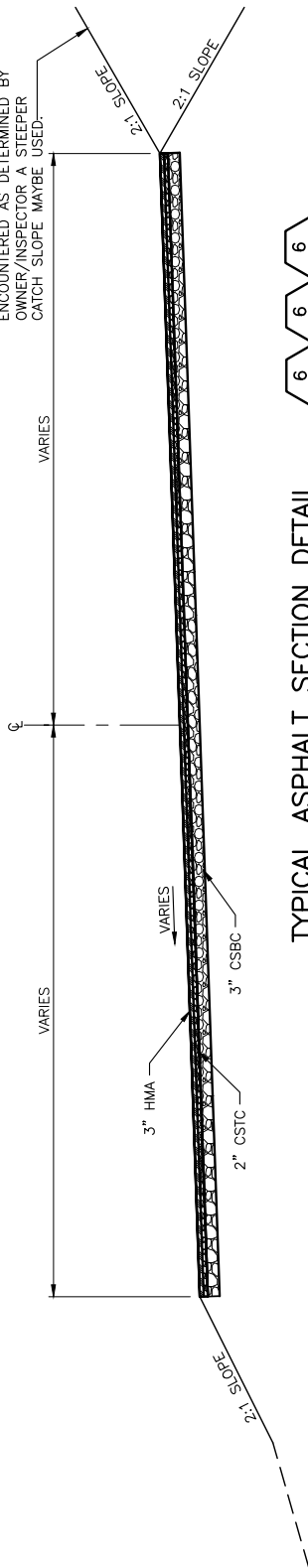

TYPICAL ASPHALT SECTION DETAIL  
SCALE: 1" = 4'

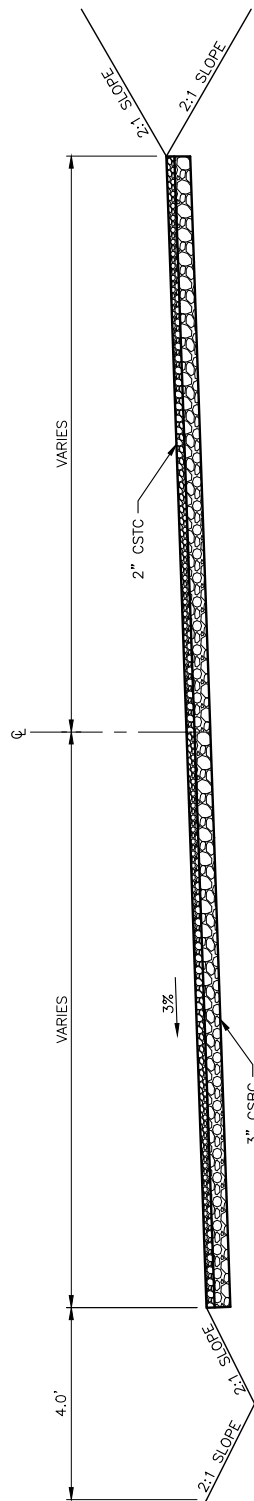

TYPICAL GRAVEL ACCESS WITH DITCH SECTION DETAIL  
SCALE: 1" = 4'

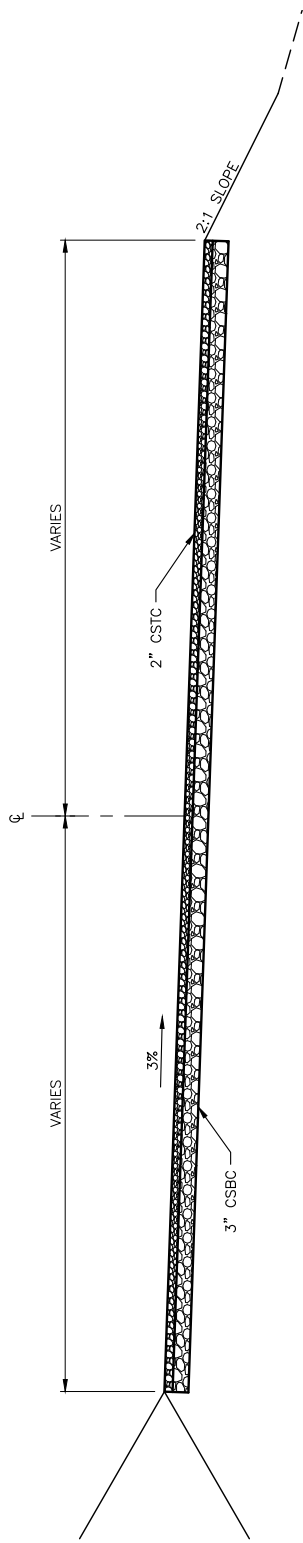

TYPICAL GRAVEL ACCESS SECTION DETAIL  
SCALE: 1" = 4'

FOR WDFW  
REVIEW ONLY

REFERENCE NUMBER:  
 APPLICANT NAME:  
 WASHINGTON DEPT. of FISH & WILDLIFE  
 PROPOSED PROJECT:  
 ACCESS DEVELOPMENT  
 LOCATION: CHAPMAN LAKE  
 SHEET 11 OF 15 DATE: 10/02/2023

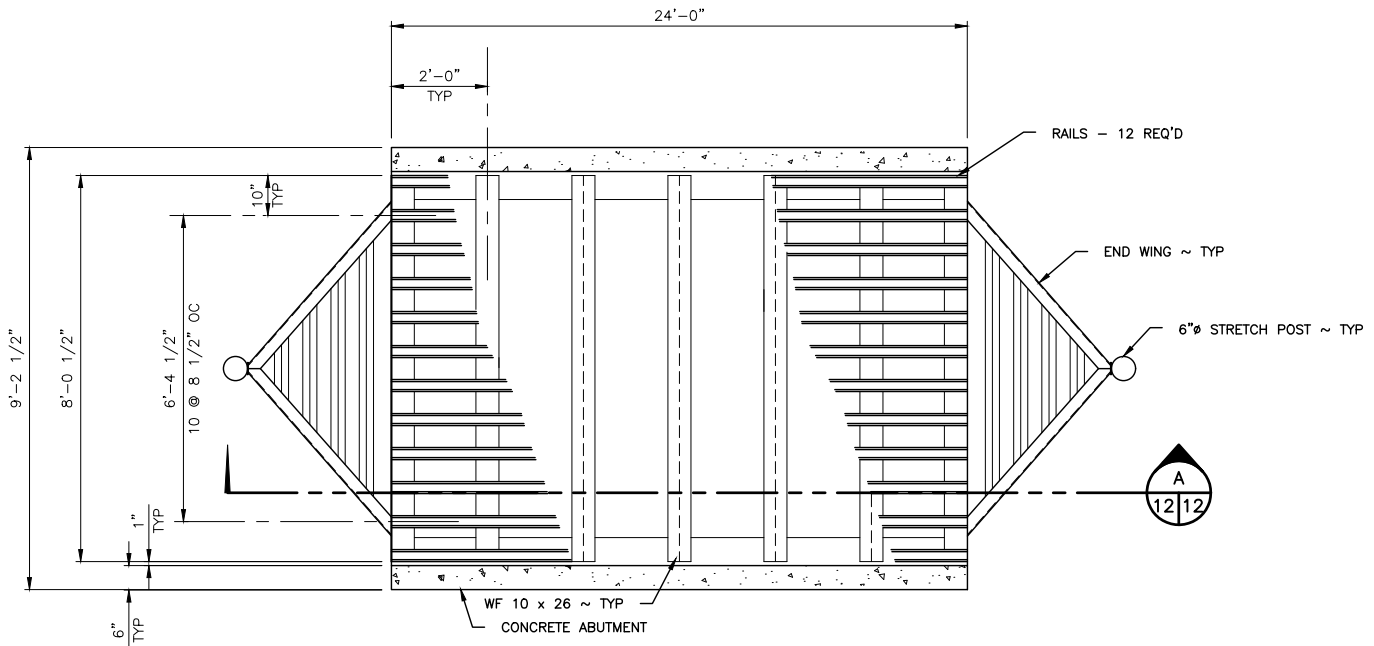

**CATTLE GUARD PLAN**

NOTH TO SCALE

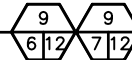

**NOTES:**

1. DESIGN LOADING SHALL MEET AASHTO HS20-44 REQUIREMENTS.
2. PROVIDE DRAINAGE AWAY FROM STRUCTURE.

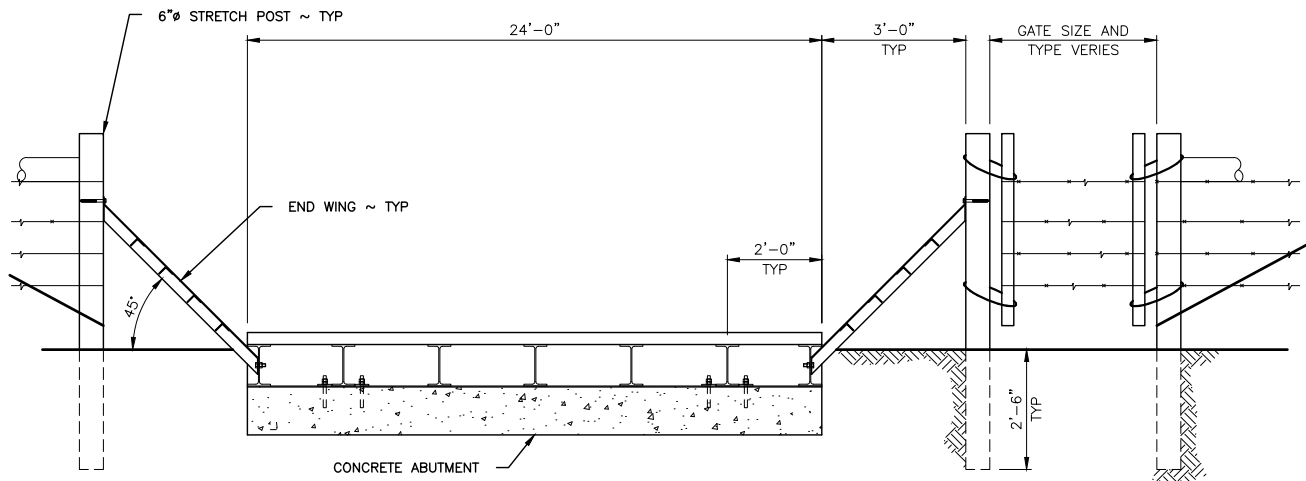

**SECTION**

NOT TO SCALE



FOR WDFW  
REVIEW ONLY

REFERENCE NUMBER:  
 APPLICANT NAME:  
 WASHINGTON DEPT. of FISH & WILDLIFE  
 PROPOSED PROJECT:  
 ACCESS DEVELOPMENT  
 LOCATION: CAPMAN LAKE  
 SHEET 12 OF 15 DATE: 10/02/2023

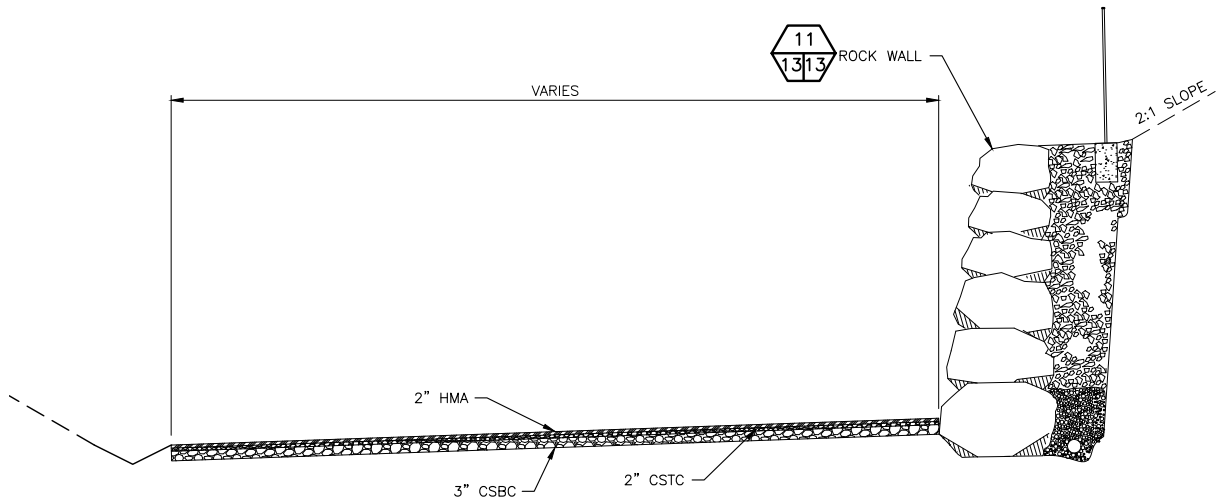

**TYPICAL BOAT RAMP TURN SECTION DETAIL**

SCALE: 1" = 5'

11  
13  
13

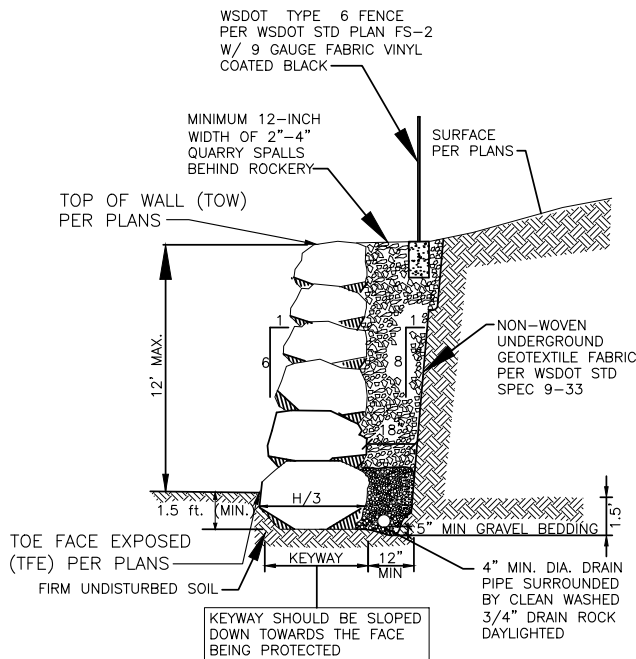

**ROCK WALL DETAIL**

(NOT TO SCALE)

11  
9  
13

- ROCKERY SHALL BE CONSTRUCTED IN ACCORDANCE WITH LOCAL STANDARDS, AND WSDOT STD SPEC 8-24.3(1).
- ROCK SHALL BE SOUND AND HAVE A MINIMUM DENSITY OF 160 POUNDS PER CUBIC FOOT MEETING WSDOT STD SPEC. 9-13.7. ROCKS WEIGHING LESS THAN 100 POUNDS SHALL NOT BE USED.
- A MINIMUM 18" THICKNESS OF BACKFILL FOR ROCK WALL PER WSDOT STD SPEC 9-13.7(2) SHALL BE PLACED BETWEEN THE ROCKERY AND THE CUT FACE, WITH A 4" DIA PERFORATED DRAIN PIPE INSTALLED AT THE BASE OF THE ROCKERY AS SHOWN.
- EXPOSED SLOPE SHOULD BE VEGETATED OR HYDROSEEDING FOLLOWING COMPLETION TO REDUCE THE POTENTIAL FOR EROSION.
- IF THE ROCKERY IS TERRACED, THE HIGHER SHALL BE SET BACK FROM THE LOWER ROCKERY A DISTANCE AT LEAST EQUAL TO THE HEIGHT OF THE LOWER ROCKERY.
- ROCKERY HEIGHTS SHALL BE NO TALLER THAN 12 FEET FOR CUT ROCKERIES.
- ROCKERIES 4' AND OVER IN HEIGHT REQUIRE A PERMIT AND INSPECTION UNIFORM BUILDING CODE SECTION 3317.1 WHICH AT A MINIMUM SHALL CONSIST OF INSPECTION AND EVALUATION OF SUB GRADE, PLACEMENT OF BASE COURSE AND DRAINAGE, AND FINISHED ROCKERY.
- ALL CAP ROCKS MUST BE SECURE AND NOT ABLE TO BE DISLODGED BY HAND. (SET TOP ROW IN CEMENT GROUT APPROX. 1-INCH THICK)

9. HEIGHT	BOTTOM SIZES	TOP SIZES
4' MAX.	4-MAN ROCK (2,000#-4,000)	1,2-MAN ROCK (50#-700#)
6' MAX.	5-MAN ROCK (4,000#-6,000#)	1,2,3-MAN ROCK (50#-2,000#)
8' MAX.	5-MAN ROCK (6,000#-8,000#)	2,3,4-MAN ROCK (450#-3,000#)
10' MAX.	6-MAN ROCK (6,000#-8,000#)	5,4-MAN ROCK (2,000#-6,000#)
12' MAX.	6-MAN ROCK (6,000#-8,000#)	5,4-MAN ROCK (2,000#-6,000#)

FOR WDFW  
REVIEW ONLY

REFERENCE NUMBER:  
 APPLICANT NAME:  
 WASHINGTON DEPT. of FISH & WILDLIFE  
 PROPOSED PROJECT:  
 ACCESS DEVELOPMENT  
 LOCATION: CAPMAN LAKE  
 SHEET 13 OF 15 DATE: 10/02/2023

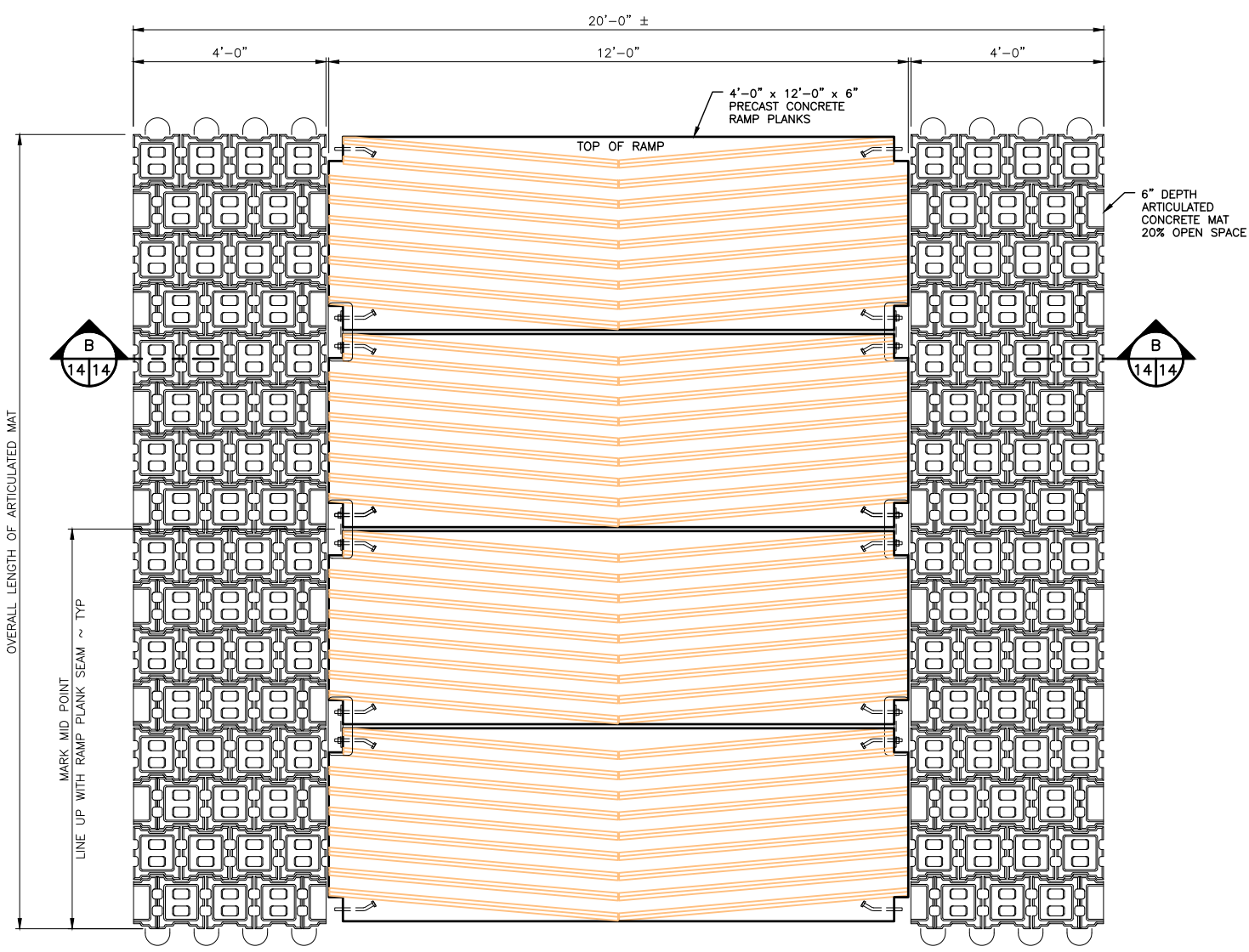

**TYPICAL RAMP PLANK PLAN**

SCALE: 1" = 1'-0"

12  
6/14

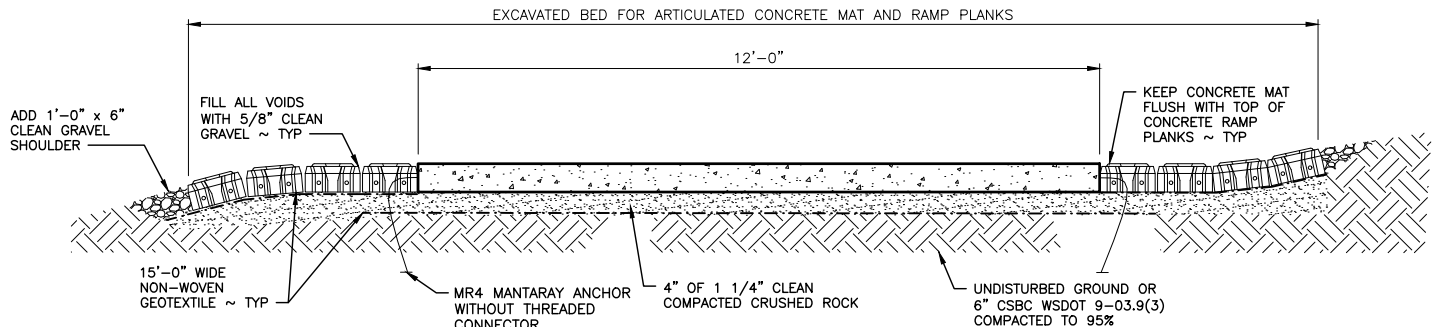

**RAMP PLANK**

NOT TO SCALE

B  
14/14

**NOTE:**

SEE SITE PLAN FOR SIZE AND LAYOUT OF ARTICULATED CONCRETE MATS

FOR WDW  
REVIEW ONLY

REFERENCE NUMBER:  
 APPLICANT NAME:  
 WASHINGTON DEPT. of FISH & WILDLIFE  
 PROPOSED PROJECT:  
 ACCESS DEVELOPMENT  
 LOCATION: CAPMAN LAKE  
 SHEET 14 OF 15 DATE: 10/02/2023

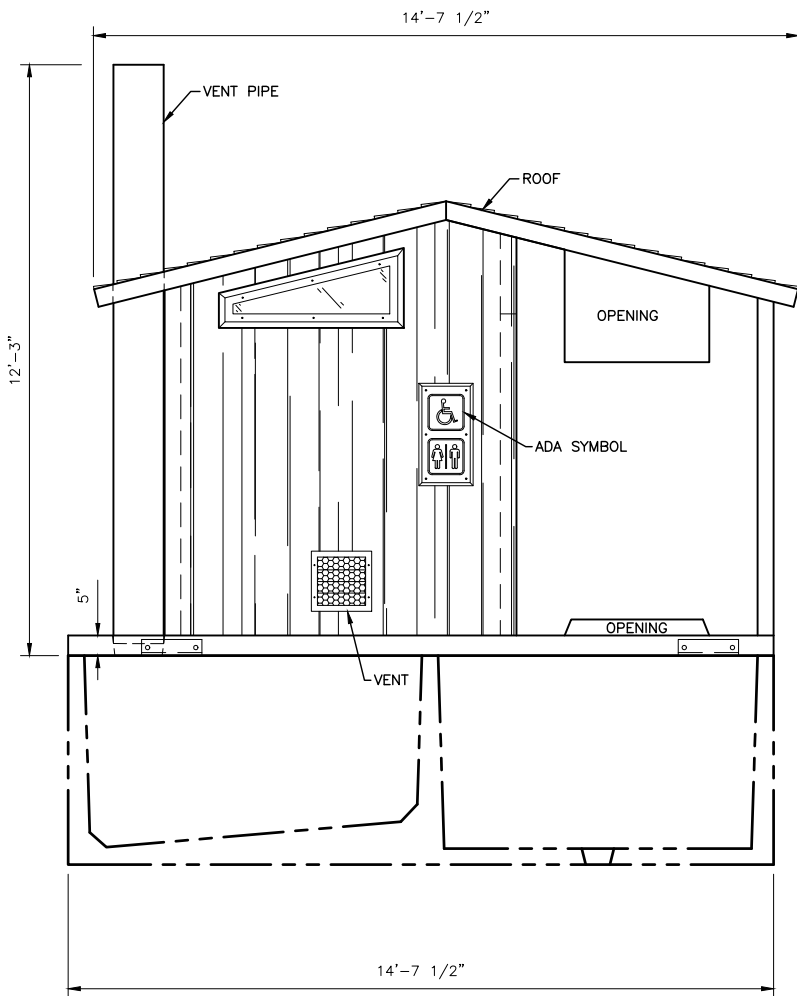

**FRONT ELEVATION**  
NOT TO SCALE

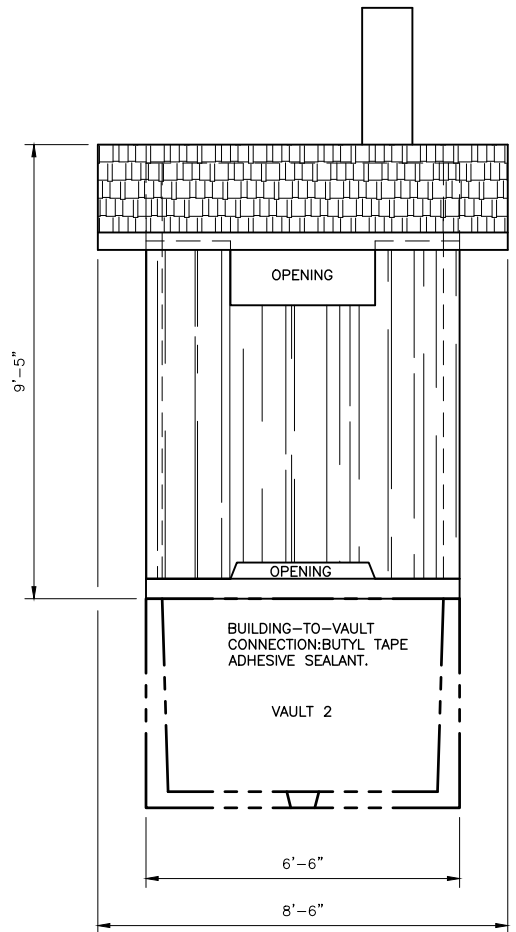

**SIDE ELEVATION**  
NOT TO SCALE

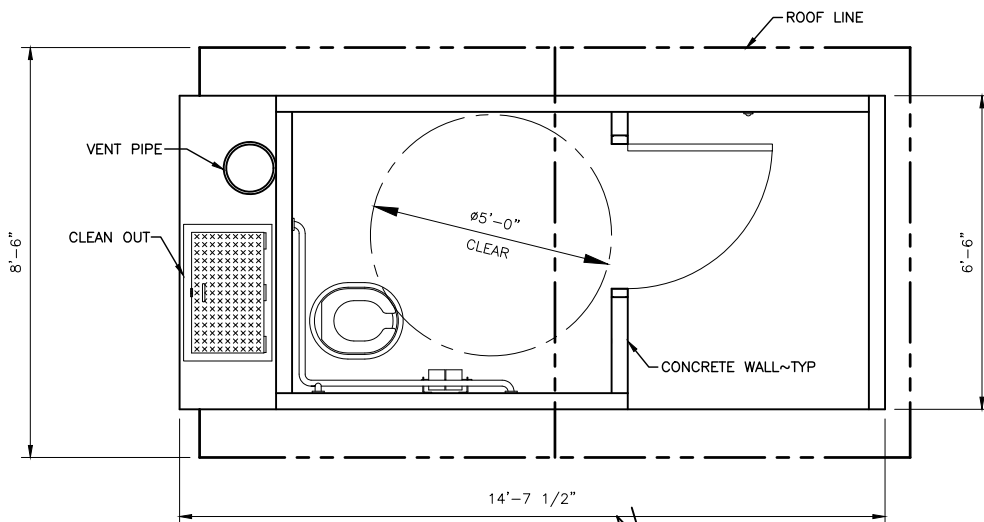

**CXT VAULT TOILET PLAN**  
NOT TO SCALE

FOR REVIEW ONLY

REFERENCE NUMBER:  
 APPLICANT NAME:  
 WASHINGTON DEPT. of FISH & WILDLIFE  
 PROPOSED PROJECT:  
 ACCESS DEVELOPMENT  
 LOCATION: CAPMAN LAKE  
 SHEET 15 OF 15 DATE: 10/02/2023